

EXISTING LAND USE ZONES

ARAM KARAKAS

LOT 42, SECTION 11, RANGE 7,
MOUNTAIN DISTRICT,
PLAN 25146

ADDRESS : 2265 ASHLEE ROAD,
NANAIMO, B.C.

PROJECT SURVEYOR

DRAWN BY : JT

DATE : MAR 1/22

OUR FILE : 90001

REVISION :



**J.E. ANDERSON
& ASSOCIATES**
SURVEYORS - ENGINEERS

1A - 3411 SHENTON ROAD, NANAIMO, B.C. V9T 2H1
TEL: 250 - 758 - 4831 FAX: 250 - 758 - 4660
E-MAIL: nanaimo@jeanderson.com
NANAIMO - VICTORIA - PARKSVILLE - CAMPBELL RIVER

LEGEND

ALL DIMENSIONS ARE IN METRES

SUBJECT TO CHARGES SHOWN
ON TITLE NO. EP39830
(P.I.D. 002-891-379)

DIMENSIONS ARE DERIVED FROM
LAND TITLE OFFICE RECORDS

THIS PLAN HAS BEEN PREPARED IN
ACCORDANCE WITH THE PROFESSIONAL
REFERENCE MANUAL

ALL DISTANCES AND AREAS SUBJECT TO
CHANGE UPON FINAL LEGAL SURVEY



The intended plot size of this plan is 432mm in width by 280mm in height (B size) when plotted at a scale of 1:400.

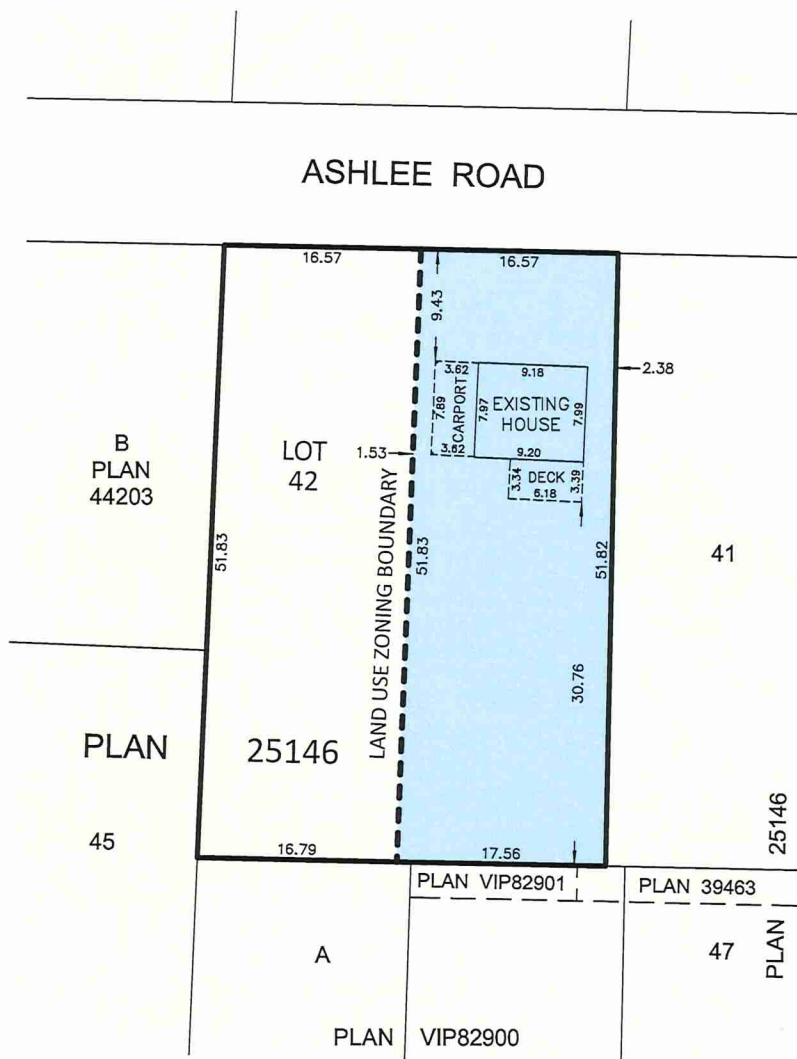

RECEIVED
RA483
2022-MAR-11
Current Planning

LEGEND

ZONE R1A SINGLE FAMILY RESIDENTIAL

ZONE R4 DUPLEX RESIDENTIAL



PROPOSED LAND USE ZONES

ARAM KARAKAS

LOT 42, SECTION 11, RANGE 7,
MOUNTAIN DISTRICT,
PLAN 25146

ADDRESS : 2265 ASHLEE ROAD,
NANAIMO, B.C.

PROJECT SURVEYOR

DRAWN BY : JT

DATE : MAR 1/22

OUR FILE : 90001

REVISION :



**J.E. ANDERSON
& ASSOCIATES**
SURVEYORS - ENGINEERS

1A - 3411 SHENTON ROAD, NANAIMO, B.C. V9T 2H1
TEL: 250 - 758 - 4831 FAX: 250 - 758 - 4660
E-MAIL: nanaimo@jeanderson.com
NANAIMO - VICTORIA - PARKSVILLE - CAMPBELL RIVER

LEGEND

ALL DIMENSIONS ARE IN METRES

SUBJECT TO CHARGES SHOWN
ON TITLE NO. EP39830
(P.I.D. 002-891-379)

DIMENSIONS ARE DERIVED FROM
LAND TITLE OFFICE RECORDS

THIS PLAN HAS BEEN PREPARED IN
ACCORDANCE WITH THE PROFESSIONAL
REFERENCE MANUAL

ALL DISTANCES AND AREAS SUBJECT TO
CHANGE UPON FINAL LEGAL SURVEY



The intended plot size of this plan is 432mm in width by 280mm in height (B size) when plotted at a scale of 1:400.

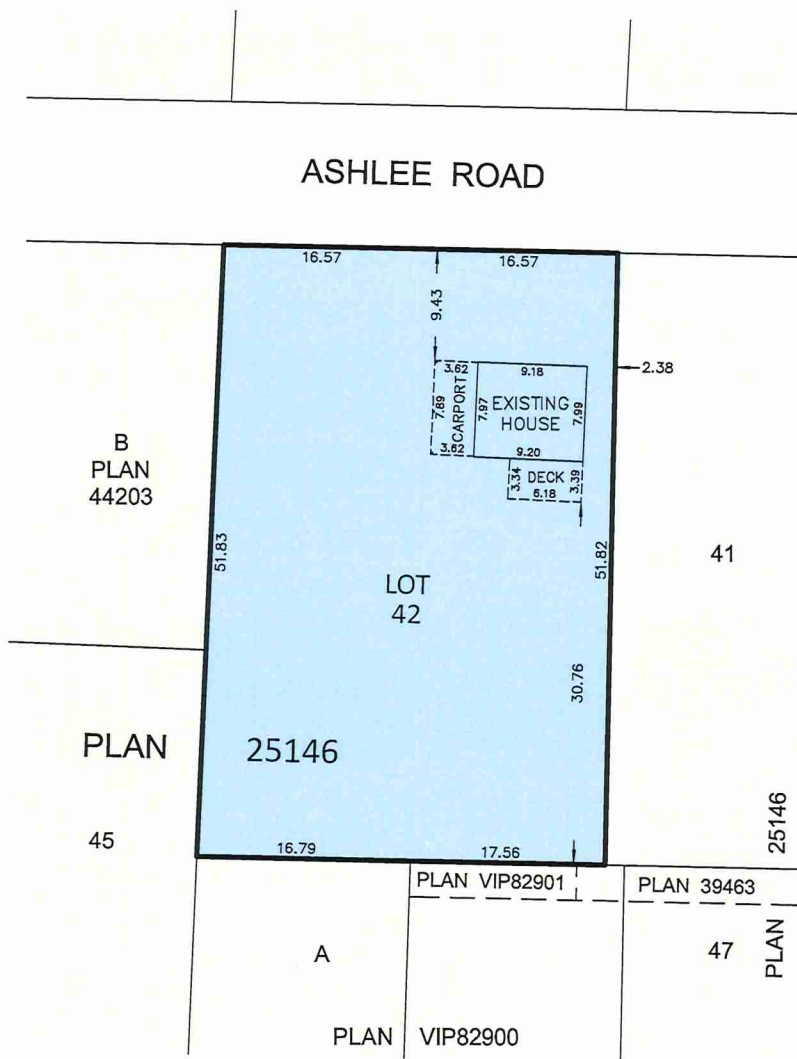

RECEIVED
RA483
2022-MAR-11
Current Planning

LEGEND

ZONE R1A SINGLE FAMILY RESIDENTIAL ☐
ZONE R4 DUPLEX RESIDENTIAL ☒